



Charles River Media, Inc.

Studio Rental Packet

Identify. Inform. Inspire.

Empowering your organization to effectively communicate your message.

73 TV Place
Needham Heights, MA 02494
617.467.5540 | info@charlesrivermedia.com



Resources at a Glance

Facility

- 30' by 23' soundstage with 14' ceiling
- Custom and stock sets available
- 20' by 40' fabric green screen
- Green room, conference room, kitchenette, and multi-purpose room
- Video feed monitoring throughout building
- Access from I-95/MA-128 and parking

Camera

- Canon C500 (1) and C300s (2)
- Sony FS7s (3)
- Lenses by Canon, Sony, and Rokinon
- Movi Pro 3-axis gimbal stabilizer
- Dana Dolly + eMotimo powered pan/tilt head

Lighting

- Full-ceiling lighting grid with industry standard LED lighting equipment
- ARRI SkyPanel, Kino Flo, Quasar, Aputure
- Dimmer Rack
- DMX lighting control
- Grip & Electric packages including C-Stands, flags, diffusion, apple boxes, etc.

Audio

- Broadcast audio mix room with X32 digital console
- 4 wireless lavalier microphones
- Assortment of wired microphones
- 2 wireless in ear monitors / IFBs for talent
- PA system for playback, telepresence, cueing
- 8 Intercom Headsets

Crew

- Producer/Director
- Director of Photography
- Camera Operator
- Gaffer
- Audio Engineer
- Hair and Makeup Artist
- Production Designer and Carpenter
- Technical Director
- Teleprompter Operator
- Graphics Operator
- Editor

Video Control Room

- Blackmagic Design ATEM 2 M/E production studio 4K switcher
- Blackmagic Design 40x40 SDI router
- Blackmagic Design Ultimatte 12 4K Keyer Advanced Compositing Processor
- vMix software switcher with virtual set capabilities
- AJA Ki Pro Ultra and Shogun record decks
- QLab playback systems
- Powerpoint/presentation PCs
- Teleprompter systems
- Video conference feed integration

Facility

- Gigabit fiber internet connection
- Backup internet connection
- Redundant stream encoders
- RTMP and SRT output to streaming platforms of your choice

Studio Dimensions

30' x 23' x 14' (to lighting grid)



Black Box Studio

All Studio Rentals Include

- Studio space
- Studio prep room
- Green room
- Conference room
- Access to kitchen area and bathrooms

Available to Rent

- Video control room
- Edit suite
- Flex space

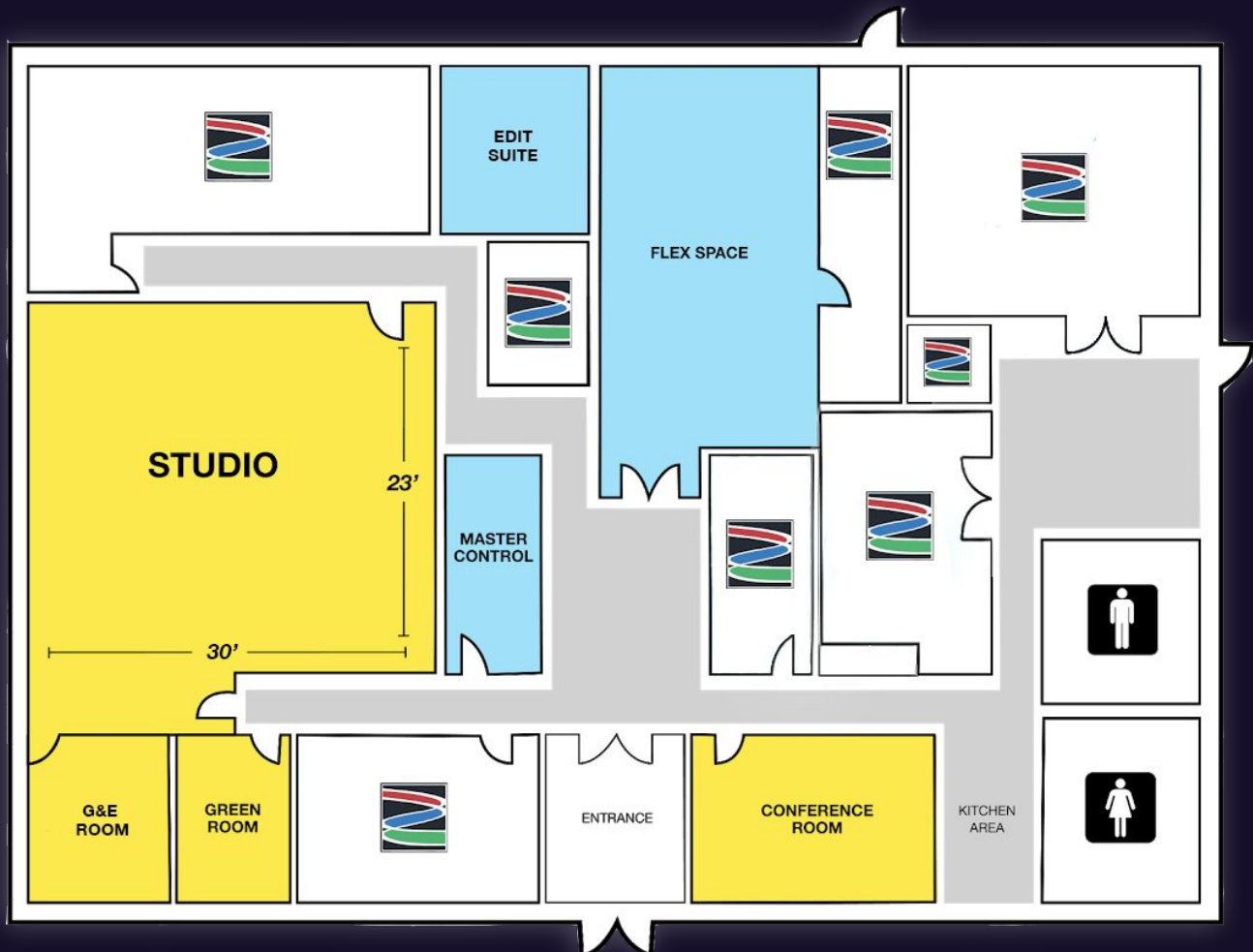

Facility Amenities



Facility Exterior



Parking Lot

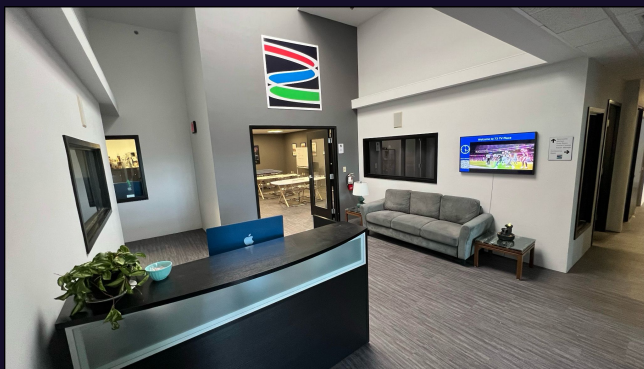

Lobby



Flex Room



Conference Room



Green Room



Kitchenette



Studio Control Room

Studio Rental Options

Option 1: Black Box Studio

Rental of the studio, conference room, and green room, without equipment or personnel. This does not include use of the flex room. Lights can be rented a la carte, pending availability (see *A La Carte - In-Studio Rentals* page).

Option 2: Studio Plus Base Lighting Package

Includes studio, conference room, and green room spaces.

This package includes the use of lights *as they are preset on the grid*. To move lights to another location on the grid, you must book a *Studio Manager* (\$800).

Grip

- (2) Combo Stands
- (6) C Stands
- (2) Baby Stands
- (1) 2x3 flag kit
- (2) 18"x24" solids
- (2) 4x4 Floppys
- (3) 6'x6' Frame with ¼ and ½ grid, magic cloth + Ultrabounce
- (6) Sand bags
- Assorted clamps
- Apple Boxes

Uncut or pay per foot:

- Duvetyne
- Assorted Diffusion

Lighting

On Grid:

- (2) Aputure 300ds mii
- (1) SkyPanel s30
- (3) 4' 2 bank Quasar Crossfade
- (1) 4' 4 bank Quasar Crossfade

On Stands:

- (2) SkyPanel S60
- (3) 4' 4 bank Kinos
- (2) 1'x2' Westcott Flex LEDs
- (2) 2' 2 bank Quasar Crossfade
- (10) 4' Quasar Rainbows

Option 3: Studio With Video Control Room

Adjacent Control Room can provide multi-camera viewing and switching (HD and 4K), as well as streaming encoders. Option for remote viewing/telepresence.

Technical Directors, Graphics Operators, Streaming Engineers, Audio Engineers, and AV assistance available.

Bundle Packages

Camera Bundle 1

Canon C500/C300

- Canon C500 mark ii and/or Canon C300 mark iii with EF mount
- Canon 24-70mm Lenses and Rokinon cine prime kit (24, 35, 50, 85mm)
- (4) 512 GB CFexpress cards
- V-Mount batteries and adapter
- Sony Vct-14 quick release tripod adapter + tripod + plate

Camera Bundle 2

Sony FS7

- Sony FS7 camera
- Metabones adapter NEX to EF
- (4) 120GB + (2) 128GB XQD cards + card reader + USB cable
- Kit zoom lens 18-135mm
- Canon EF 24-70mm
- Canon EF 85mm
- Stock microphone
- Batteries (small Sony, large and XL)
- SHAPE Sony FS7 bundle rig
- SHAPE Sony FS7 remote extension handle
- Sony Vct-14 quick release tripod adapter + tripod + plate

Sound Studio Bundle

- Sound Devices 633 - 6 channel recorder
- Sennheiser MKH 50 super-cardioid mic
- Sennheiser MKH 416 shotgun mic
- Tram TR-50 lav (hardwired)
- Sanken Cos-11D lav (hardwired)
- Boom pole + holder
- Sound blankets
- XLR cables

Dolly Studio Bundle

- Dana Dolly
- 6' or 10' pipe
- eMotimo Spectrum ST4 + FIZ motor + Dana Dolly Integration Kit + (2) V-Mount batteries and charger
- Low Boy combo stands

In-Studio Set Examples

Basic Option

- Seamless paper roll included for floor-to-ceiling use: white (12'), black (12'), or green (9')
- Pre-built Home Office Set

Additional Cost

- Frosted Panels with Quasar Rainbow Backlights
- 20'x40' Green Screen
- Branded Fabric Backdrop

Custom Set

Custom Set Construction created by our Production Designer.

Basic Option



Set Designs and Builds

Our production design team conceptualizes custom sets that carpenters and scenic artists bring to life in our studio.

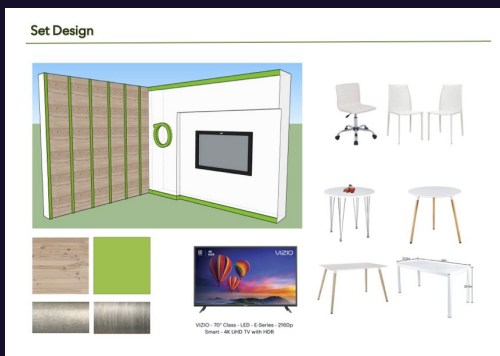

Set Examples

Custom Set Construction



Set Examples

Additional Cost



A La Carte - In Studio Rentals

Lighting

Preset on Grid

- (includes iPad for DMX control)
- (2) Aputure 300ds mii
- (1) SkyPanel s30
- (3) 4' 2 bank Quasar Crossfade
- (1) 4' 4 bank Quasar Crossfade

LED

- (2) Aputure 1200d
- (2) Aputure 600x
- (1) Flex Light Cine Kit: 2 lights
- (1) SkyPanel S30
- (2) SkyPanel S60
- (2) Chimera for SkyPanel
- (2) 2' Rainbow Quasar
- (10) 4' Rainbow Quasar
- (2) 2' 2 bank Quasar Crossfade

Fluorescent

- (4) 4' 4 bank Kino (2700, 3200, & 5600 tubes)

Grip

- (2) Beefy Baby 2R
- (8) C Stands
- (2) 2 Combo 2R
- (1) 2x3 Flag Kit
- (1) 18"x24" Flag Kit
- (2) 18"x48" Flags
- (2) 4'x4' solid floppy
- (3) 6'x6' Frame with ¼ and ½ grid, magic cloth & Ultrabounce
- (4) Full Apple Box
- (3) Half Apple Box
- (3) Quarter Apple Box
- (3) Pancake

Expendables - Pay by the Foot

- Assorted Diffusion
- Duveltyne
- Gaff Tape

Additional Rentals

- Atomos Shogun 4K HDMI/12GSDI Recorder + 7" Monitor
- AJA Ki Pro Ultra 12G Multichannel Recorder
- 6 Wireless communications headsets+ base station with 2 channels
- (3) 43" LCD HD TV monitor
- (2) Presentation slideshow PC
- Laptop with SDI capture card(for remote Zoom feed)
- (3) Teleprompter
- Dana Dolly
- eMotimo Spectrum ST4 + FIZ Motor + Dana Dolly Integration Kit
- 12' White Seamless Paper Roll
- 9' Seamless Paper Roll (white, black, gray, chroma green, dark green, blue, red)
- 20' x 40' Frame + Fabric Green Screen
- Frosted Panels with Quasar Rainbow Backlights

Crew

- Studio Manager
- Producer/Director
- Director of Photography
- Camera Operator
- Gaffer
- Audio Engineer
- Hair and Makeup Artist
- Production Designer
- Technical Director
- Teleprompter Operator
- Graphics Operator
- Editor

Catering

Pressed Catering

(857) 404-0192

www.pressedcafe.com/cafe-menu-newton

300 Needham Street, Newton, MA 02459

Grape Leaf

(617) 527-5366

www.grapeleafnewton.com/menu

6 Lincoln Street, Newton, MA 02461

Panera Bread

(781) 453-4005

www.panerabread.com

120 Highland Ave, Needham, MA 02494

Hungry Coyote

(781) 292-1004

1185 Highland Ave, Needham, MA 02492

New England Soup Factory

(617) 558-9988

www.newenglandsoupfactory.com/menu/

244 Needham Street, Newton, MA 02464

Manow Thai

(617) 244-2858

www.manowthaikitchen.com/all-menu

1138 Beacon Street, Newton, MA 02461

Dave's Hot Chicken

(857) 328-1777

www.daveshotchicken.com/

141 Needham Street, Newton, MA 02461

B.Good

(617) 467-4143

www.Bgood.com

55 Needham Street, Newton, MA 02461